



HYPERFLOW CARBON FIBER COLD AIR INTAKE



AUDI S3 TT 8J

USER MANUAL

ARMA Warranty Terms

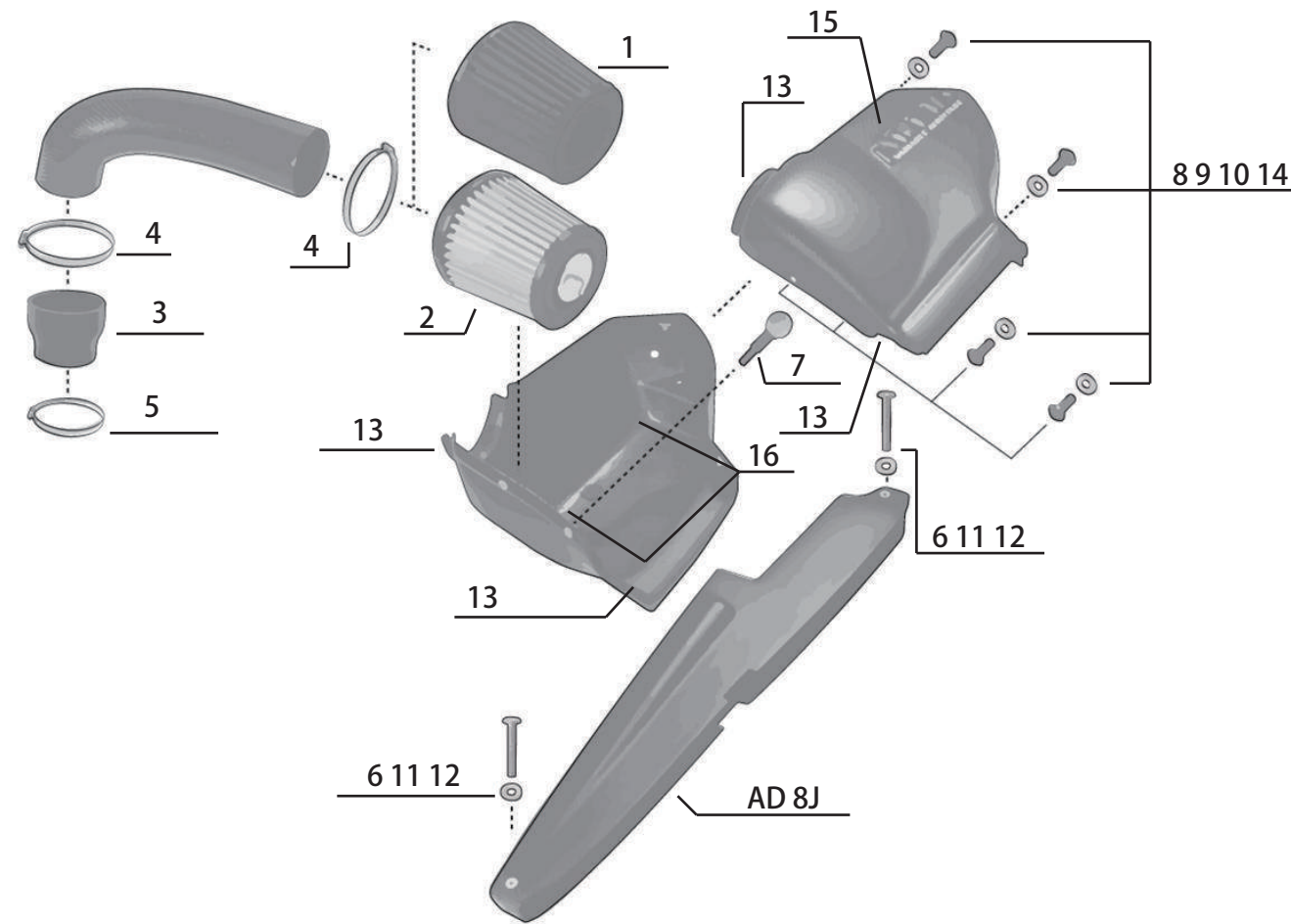

Following have been combine

Drawing No.	PART	No.	Quantity
13	n type rubber	CS50-01-0008	1
14	M4 BLIND JACK NUT	CG46-10-0292	4
15	Metal nameplates	CG40-10-0005	1
16	12mm Plastic plugs-1	SS01-0000011	2

DIY Parts

Drawing No.	PART	No.	Quantity
VW	GOLF 7 2.0 GTI INTAKE	ARMAGOLF7G-A	1
VW 20T	VW FONT INTAKE COVER(Special part)	ARMAGOLF7G-3	1
ADS3	AUDI FONT INTAKE COVER(Special part)	ARMAAUDIS3-1	1
AD8J	AUDI FONT INTAKE COVER(Special part)	ARMAAUDITT-1	1
1	Air Filter 138Height X 93 Wide	CS56-AR60039	1
2	RS Air Filter 138Height X 93 Wide	CS56-AR60038	1
3	70mm to 89mm Silica Hose	SS01-0000079	1
4	Hose Clamp	CG45-10-0019	2
5	Hose Clamp	CG45-10-0001	1
6	CAP M5*20mm Screws	CG46-10-0072	2
7	S FILTER	CS92-01-0001	1
8	CAP M4*12mm Screws	CG46-10-0079	4
9	M4mm Washers	CG48-10-0023	4
10	M4 Spring Washers	FG55-01-0042	4
11	M5 Washers	CG48-10-0018	2
12	M5 Spring Washers	CG48-10-0024	2

WiFi Modul is for option

Drawing No.	PART	No.	Quantity
	WiFi Module	EC300000000-	1

ECV not Include OBD2

Drawing No.	PART	No.	Quantity
	ECV box	CG83-01-0045	1
	Remote Control	BG16-01-0052	1
	V1 Control & Power Wire	EC4000000000	1
	V2 Control Wire	EC5000000000	1
18	Solenoid Valve	CG83-01-0058	1
	ECV Antenna and Speaker	CG83-01-0135	1
	Check Valve	CG83-01-0059	1

ECV OBD2

Drawing No.	PART	No.	Quantity
	ECV Control box(OBD2 Version)	CG83-01-0082	1
	Remote Control	BG16-01-0052	1
	OBD2 Connector	BG22-01-0002	1
	V1 Control & Power Wire	EC4000000000	1
	V2 Control Wire	EC5000000000	1
	Solenoid Valve	CG83-01-0058	1
	ECV Antenna and Speaker	CG83-01-0135	1
	OBD2 Cable(car)	BG22-01-0003	1
	Check Valve	CG83-01-0059	1
	3-Way Valve	BG53-30-0010	1

Warranty Period

Hardware: 6 months / 10,000 km from the date of purchase. Non-transferrable.
Software(electronic): 1 year / 30,000 km from the date of purchase. Non-transferrable.
(Accessories which include wires, batteries, solenoid valve, one-way check valve, vacuum tube etc. are excluded from the warranty.)
Air filter is not under the warranty.

Disclaimer of Warranty

- To accommodate the local weather, most of Car Company would adjust little bit different for the ECU. As changing intake or exhaust system would cause engine lights on, the purpose of ARMA is to help car user to have best efficiency. ARMA will not guaranty and offer warranty for the sense of driving, change gears, torque limit, engine light on, etc. Please kindly understand any modification may cause risk.
- This product is designed to improve car performance for everyday driving. This warranty becomes invalid if the product is used in race or competition.
- ARMA Limited Warranty does not cover any damage to the product caused in whole or in part by force majeure or harsh riding characteristics.
- Manufacturer shall NOT be liable for incidental or consequential damages whatsoever and in no case shall Manufacturer be responsible for any damages exceeding the original purchase price of the product.
- Purchaser understand and agree only ARMA has right to amend the terms of use, as any agents or performance car shops cannot violet the statement.
- All performance parts or systems should be installed by mechanics who are experienced in the installation and proper operation. The warranty is void if the product is misused or alters the design and disassembling without authorization of Manufacturer, or failure to follow Manufacturer's instructions to install and maintain.
 - Improper installation: If the vacuum valve is directly installed right above the exhaust pipe, it will cause a certain degree of damage to the valve after long-term use. The ECV box only must be located in the driver cabin, or the warranty will be void.
 - As the installation manual has no notify, please do not drill, trim, paint, modified... etc. In addition, please do not destroy or change the function, outside look and setting method. Otherwise, it will not be under the warranty.
 - Hot swapping: A hot swap of electronics is strictly prohibited. It will cause a direct damage to the electronic units.
 - Avoid damaging to AMRA objects during cutting or installation, or reversing the polarity.
 - Electronic units being damped is not covered under ARMA warranty.

Limited Warranty

ARMA ("Manufacturer") warrants to the original buyer that this product is free from manufacturing defects in materials and workmanship in the limited duration. If the product is found to be defective, in Manufacturer's sole judgment, it will be either repaired or replaced by a new product, and the buyer shall be liable for return shipping/handling fees. If this products has been stop for production, we'll only take repair, but no exchange.

If you have any questions about our warranty terms, please send an email directly to: service@armaspeed.com

Tel : +886-6-5930028 E-mail : info@armaspeed.com Web : www.armaspeed.com



All performance parts or systems should be installed by mechanics who are experienced in the installation and proper operation. The warranty is void if the product is misused or alters the design and disassembling without authorization of Manufacturer, or failure to follow Manufacturer's instructions to install and maintain.



When fastening metal hose clamp, recommended torque value 1.5N/M, over-tightening might result in deformation or crack.

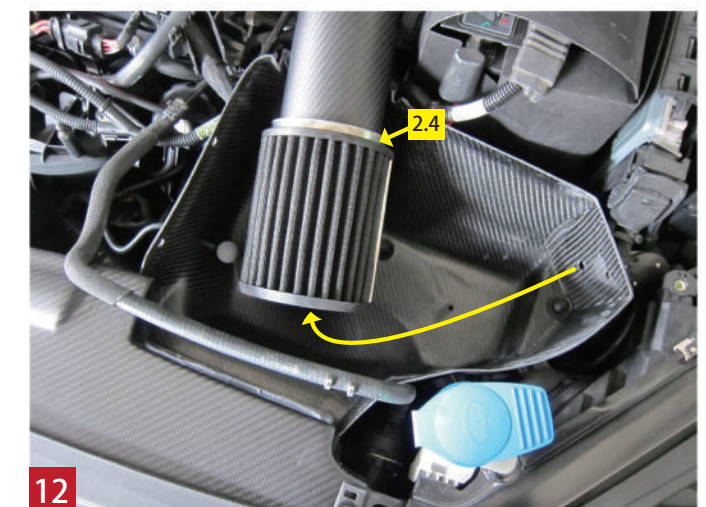
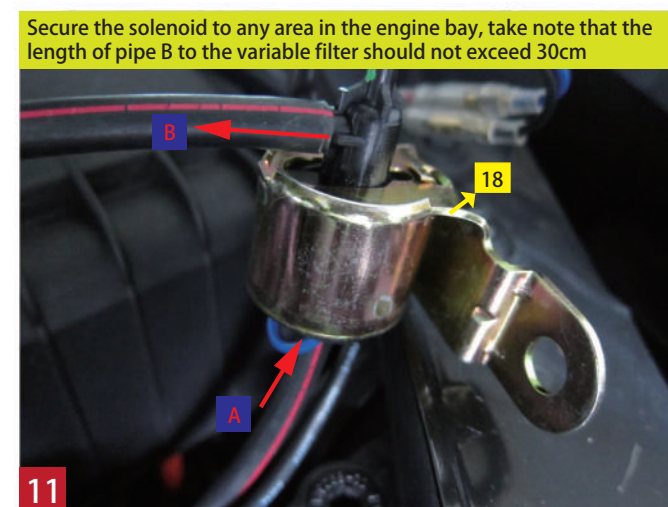
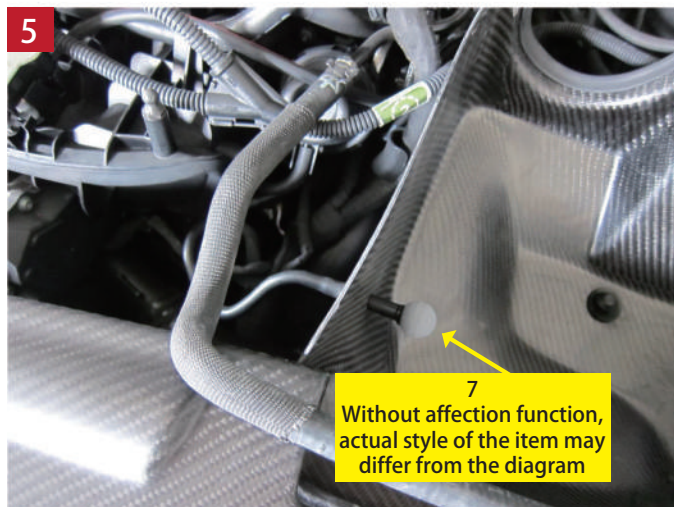
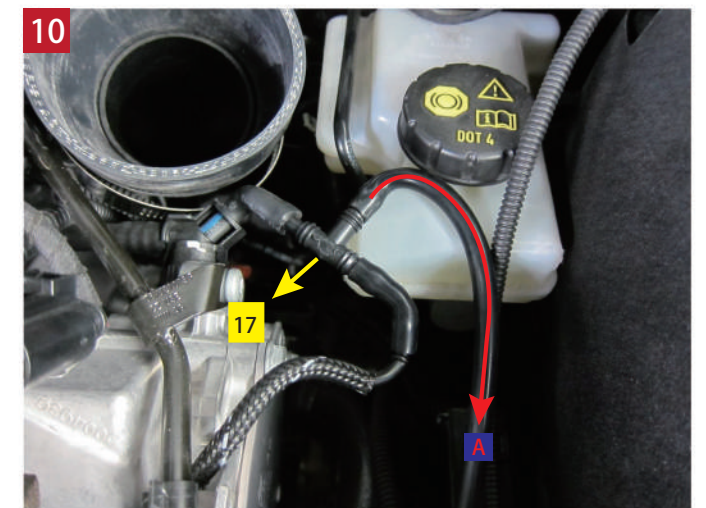
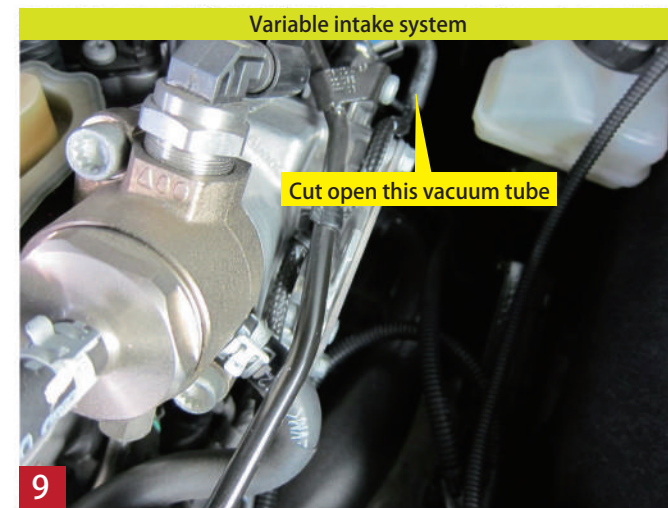
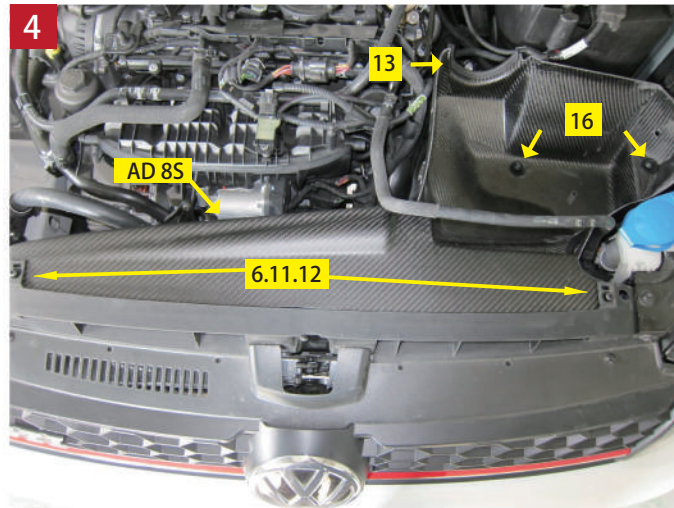

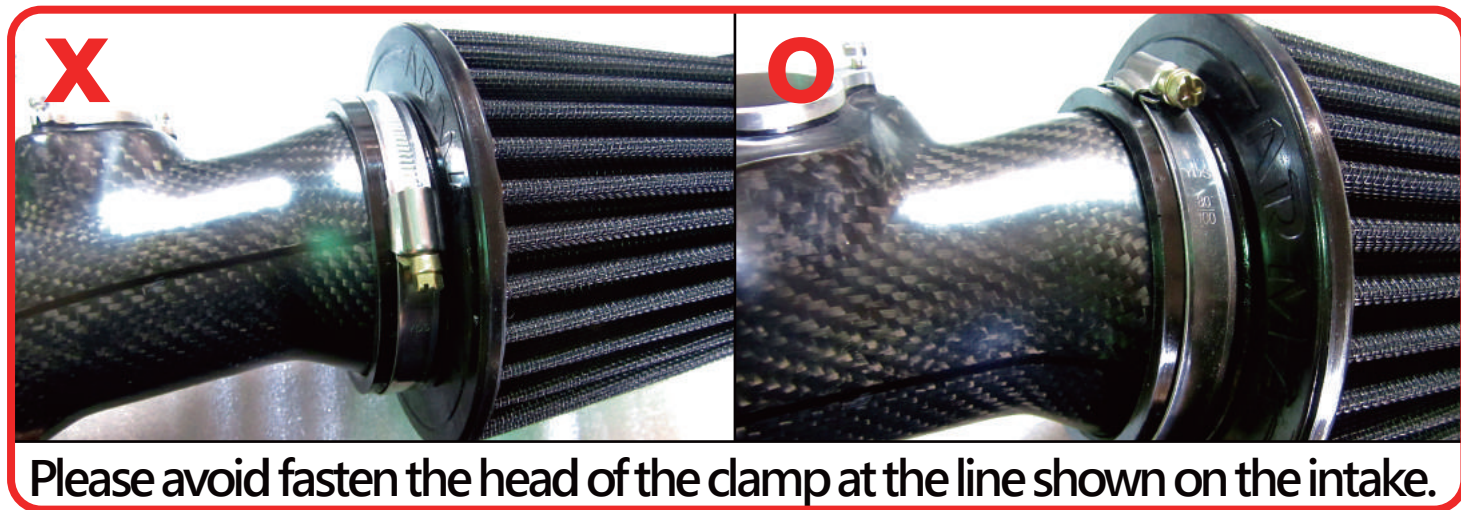

Please avoid fasten the head of the clamp at the line shown on the intake.